

CST-E2 PLAIN TROLLEY

INSTRUCTION BOOK

Safety Warning

1. Do not exceed rated load capacity.
2. Never lift people or hoist loads over people.
3. Stay clear of load when raising, lowering or moving a suspended load.
4. Examine plain trolley before using. Components may be affected by exposure to chemicals, salts, and rust.

Operation

1. Place the load directly under the plain trolley.
2. Attach appropriate couplings from suspender plate (#13) to load and hoist up to desire height.
3. Push the load to move trolley along its track, do not allow the load to swing.

Caution

If the trolley does not move when the load is pushed firmly, stop operating and check for obstacles on the I beam that may be obstructing the trolley.

Maintenance

1. Periodically grease bearing, gear, and I-beam surface.
2. Periodically examine all bolts and nuts for tightness.

CST-E2 PLAIN TROLLEY

ASSEMBLY INSTRUCTIONS

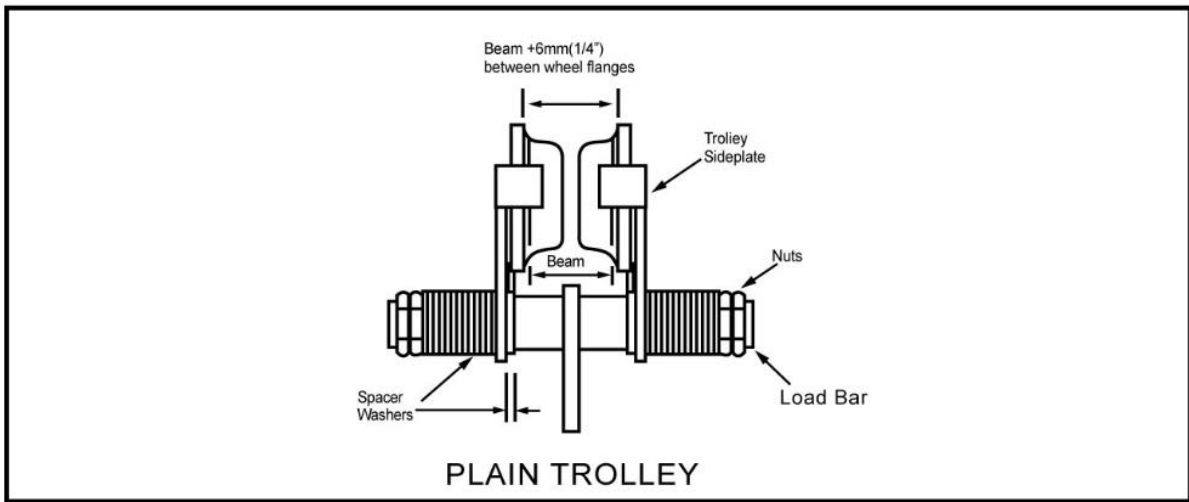

ASSEMBLE AS FOLLOWS

1. Measure the actual width of the Runway Beam.
2. Assemble the required number of Spacer Washers equally to the inside of the Trolley Side Plates so that the dimension between Trolley Wheel Flanges is 6mm or 1/4" (Max) greater than the Runway Beam width. Assemble the remaining washers outside the Trolley Sideplate and fit Nuts to load bar.

There must always be at least one washer on the inside and the outside of each trolley side plate.

3. Slacken off the load bar Nuts and spread the Side Plates so that the wheels can be slipped up over the Runway Beam. Screw the Nuts firmly against the Washers, then suspend a light load from the Trolley to ensure that all four Wheels contact the Runway Beam. Screw the Nuts tightly against the Washers then secure with split pins.

NUTS MUST BE TIGHT

4. Suspend the Maximum Safe Working Load for the Trolley then run the unit slowly along the full length of the Runway to ensure satisfactory operation.

CST-E2 PLAIN TROLLEY

ASSEMBLY DRAWING AND PARTS LIST

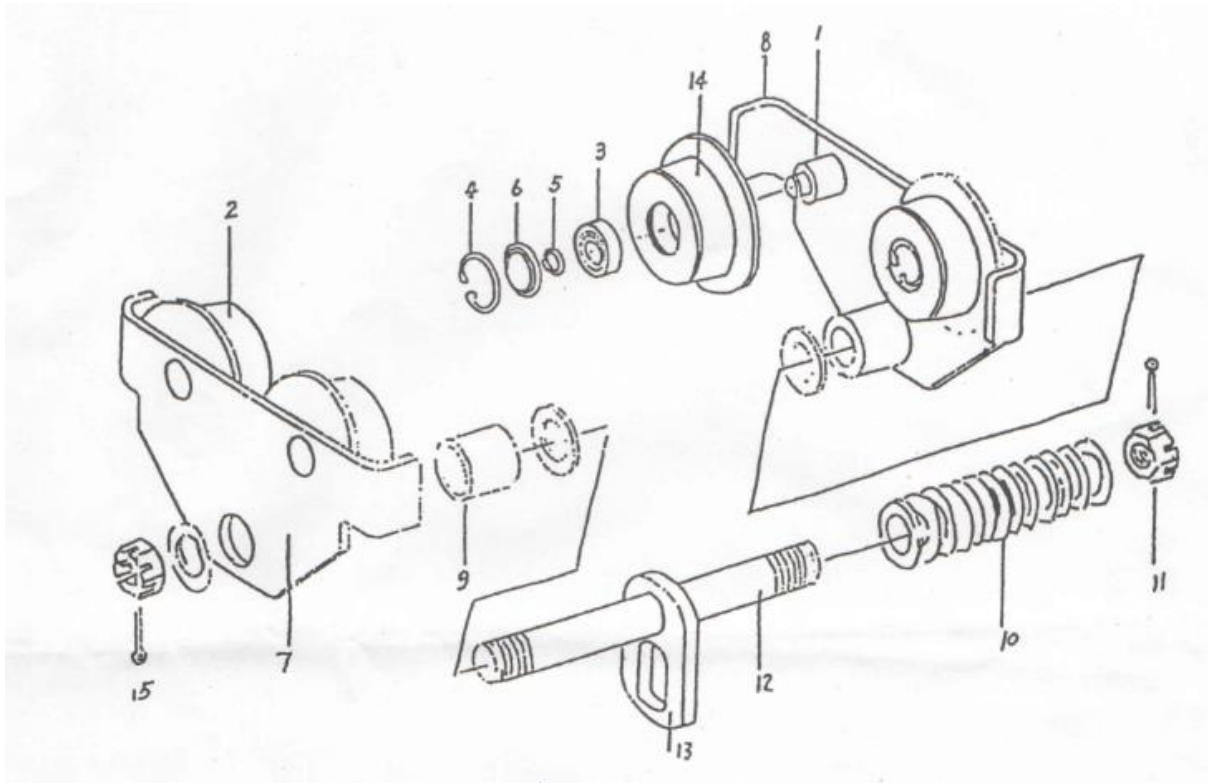

Item #	Description	Quantity
1	Axle	4
2	Plain Wheel	2
3	Bearing	4
4	Ret Clip	4
5	Cir Clip	4
6	Spacer	4
7	Right Side Plate	1
8	Left Side Plate	1
9	Spacer	2
10	Spacer Washer	-
11	Nut	2
12	Load Bar	1
13	Suspender Plate	1
14	Plain Wheel	2
15	Cotter Pin	2

CST-E2 PLAIN TROLLEY

SPECIFICATIONS

Model			0.5t	1t	2t	3t	5t	10t
Rated Capacity ton			0.5	1	2	3	5	10
Test Load kN			6.25	12.5	25	37.5	62.5	125
Min Radius of curve m			0.9	1	1.1	1.3	1.4	1.7
Dimensions mm	A	Pylon	264	335	353	371	393	436
		Lengthen Pylon	315	437	455	473	490	532
		B	216	260	300	345	390	470
		C	195	239	286	336	393	500
		E	31	32.5	31	35	37	45
		F	~3					
		H	110	136	161	185	220	280
Adjustable Beam Width mm	M	Pylon	64~152	64~103	88~203	102~203	114~203	117~203
		Lengthen Pylon	68~203	102~305	102~305	102~305	108~305	117~305
Net Weight kg		Pylon	8.6	15.4	23	40	50	97
		Lengthen Pylon	9.2	16.6	25.1	43.8	53.8	102.5